

M3 Junction 9 Improvement

Scheme Number: TR010055

2.11 Traffic Regulation Measures Plans (Rev 1)

APFP Regulations 5(2)(o)

Planning Act 2008

**Infrastructure Planning (Applications: Prescribed Forms and
Procedure) Regulations 2009**

Volume 2

15 June 2023



NOTES
 Purpose of use
APPLICATION SUBMISSION
 Development Consent Order Number / Document
 TR010055/2.11

1. THIS DRAWING HAS BEEN PRODUCED USING CAD SOFTWARE. THEREFORE ALL DIMENSIONS ARE SHOWN IN METRES UNLESS SHOWN OTHERWISE.
 2. DO NOT SCALE FROM THIS DRAWING. USE ONLY PRINTED DIMENSIONS.

KEY TO SYMBOLS
 DEVELOPMENT CONSENT ORDER BOUNDARY

REV	DATE	REVISION NOTE	ORIG	CHKD	APPD
0	NOVEMBER 2022	APPLICATION SUBMISSION	GP	LC	MF

DESIGNER

CONTRACTOR

CLIENT



PROJECT TITLE
 M3 JUNCTION 9 IMPROVEMENT SCHEME

PROJECT STAGE
 PCF STAGE 3

DRAWING TITLE
 TRAFFIC REGULATION MEASURES
 APFP REGULATION S(2)(c)
 KEY PLAN
 DOCUMENT REFERENCE: 2.11

SUITABILITY
 APPLICATION SUBMISSION
 SHEET SIZE: A1 SCALE: 1:12500 STATUS: REV 0
 DRAWING NUMBER
 HES51511-VFK-LSI-X_XXXX_XX-DR-ZL-6022

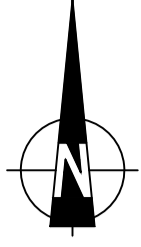
© Crown copyright and database rights 2022. Use of this data is subject to terms and conditions. Ordnance Survey Licence 100030649.



BASINGSTOKE

NOTES

Purpose of use
APPLICATION SUBMISSION

Development Consent Order Number / Document
TR010055/2.11

- THIS DRAWING HAS BEEN PRODUCED USING CAD SOFTWARE. THEREFORE ALL DIMENSIONS ARE SHOWN IN METRES UNLESS SHOWN OTHERWISE.
- DO NOT SCALE FROM THIS DRAWING. USE ONLY PRINTED DIMENSIONS.
- PROPOSED EARTHWORK EMBANKMENTS / CUTTINGS HAVE BEEN OMITTED FOR CLARITY.
- THE DESIGN SHOWN WILL BE SUBJECT TO DETAILED DESIGN DEVELOPMENT IN ACCORDANCE WITH THE PROVISIONS OF THE DEVELOPMENT CONSENT ORDER.

KEY TO SYMBOLS

- DEVELOPMENT CONSENT ORDER BOUNDARY
- LAND NOT INCLUDED IN ORDER LIMITS
- PROPOSED ROAD MARKINGS
- PROPOSED CLEARWAY EXTENTS
- PROPOSED PROHIBITION OF OVERTAKING EXTENTS
- START / END POINT OF RESTRICTION AS DETAILED IN SCHEDULE 3 OF THE DEVELOPMENT CONSENT ORDER



01	JUNE 2023	DEADLINE 2	EO	LC	MF
0	NOVEMBER 2022	APPLICATION SUBMISSION	GP	LC	MF
REV	DATE	REVISION NOTE	ORIG	CHKD	APPD

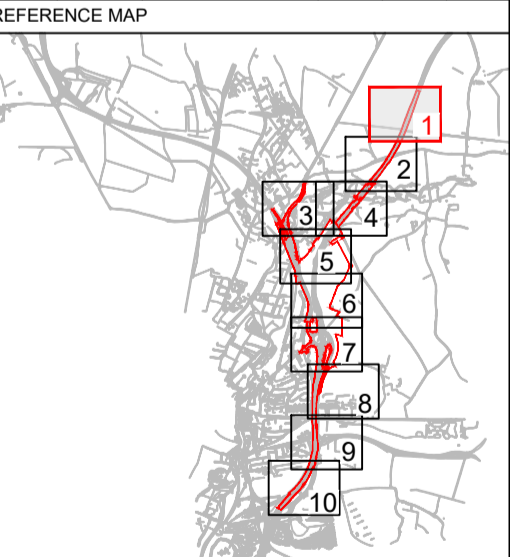

DESIGNER

CONTRACTOR

CLIENT

PROJECT TITLE
M3 JUNCTION 9 IMPROVEMENT SCHEME

PROJECT STAGE
PCF STAGE 3

DRAWING TITLE
**TRAFFIC REGULATION MEASURES
APFP REGULATION S(2)(c)
SHEET 1 OF 10
DOCUMENT REFERENCE: 2.11**

SUITABILITY
APPLICATION SUBMISSION

SHEET SIZE: A1 SCALE: 1:1,250 STATUS: REV 01
DRAWING NUMBER
HES51511-VFK-LSI-X_XXXX_XX-DR-ZL-6023

FOR CONTINUATION SHEET 2 OF 10

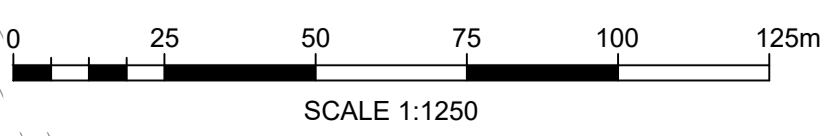

© Crown copyright and database rights 2022. Use of this data is subject to terms and conditions. Ordnance Survey Licence 100030649

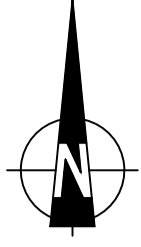

FOR CONTINUATION SHEET 1 OF 10

NOTES

Purpose of use
APPLICATION SUBMISSION

Development Consent Order Number / Document
TR010055/2.11

- THIS DRAWING HAS BEEN PRODUCED USING CAD SOFTWARE. THEREFORE ALL DIMENSIONS ARE SHOWN IN METRES UNLESS SHOWN OTHERWISE.
- DO NOT SCALE FROM THIS DRAWING. USE ONLY PRINTED DIMENSIONS.
- PROPOSED EARTHWORK EMBANKMENTS / CUTTINGS HAVE BEEN OMITTED FOR CLARITY.
- THE DESIGN SHOWN WILL BE SUBJECT TO DETAILED DESIGN DEVELOPMENT IN ACCORDANCE WITH THE PROVISIONS OF THE DEVELOPMENT CONSENT ORDER.

KEY TO SYMBOLS

- DEVELOPMENT CONSENT ORDER BOUNDARY
- LAND NOT INCLUDED IN ORDER LIMITS
- PROPOSED ROAD MARKINGS
- PROPOSED CLEARWAY EXTENTS
- PROPOSED PROHIBITION OF OVERTAKING EXTENTS
- START / END POINT OF RESTRICTION AS DETAILED IN SCHEDULE 3 OF THE DEVELOPMENT CONSENT ORDER

ABBOTS WORTHY

B3047

M3

B3047

B3047

RIVER ITCHEN

RIVER ITCHEN

FOR CONTINUATION SHEET 3 OF 10

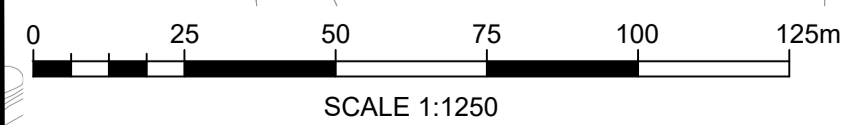

01	JUNE 2023	DEADLINE 2	EO	LC	MF
0	NOVEMBER 2022	APPLICATION SUBMISSION	GP	LC	MF
REV	DATE	REVISION NOTE	ORIG	CHKD	APPD

REFERENCE MAP

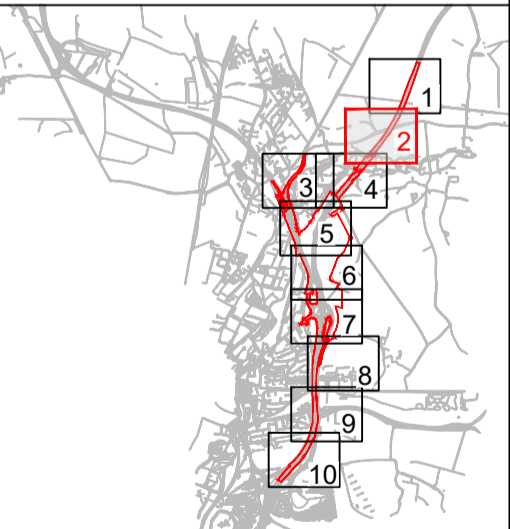

DESIGNER

CONTRACTOR

CLIENT

PROJECT TITLE
M3 JUNCTION 9 IMPROVEMENT SCHEME

PROJECT STAGE
PCF STAGE 3

DRAWING TITLE
TRAFFIC REGULATION MEASURES
APFP REGULATION S(2)(c)
SHEET 2 OF 10
DOCUMENT REFERENCE: 2.11

SUITABILITY
APPLICATION SUBMISSION

SHEET SIZE: A1 SCALE: 1:1,250 STATUS: REV 01
DRAWING NUMBER
HES51511-VFK-LSI-X_XXXX_XX-DR-ZL-6024

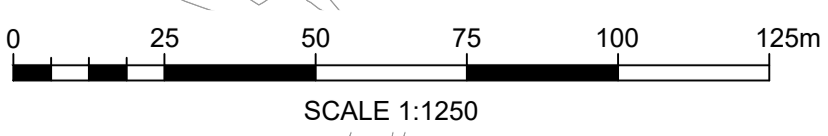
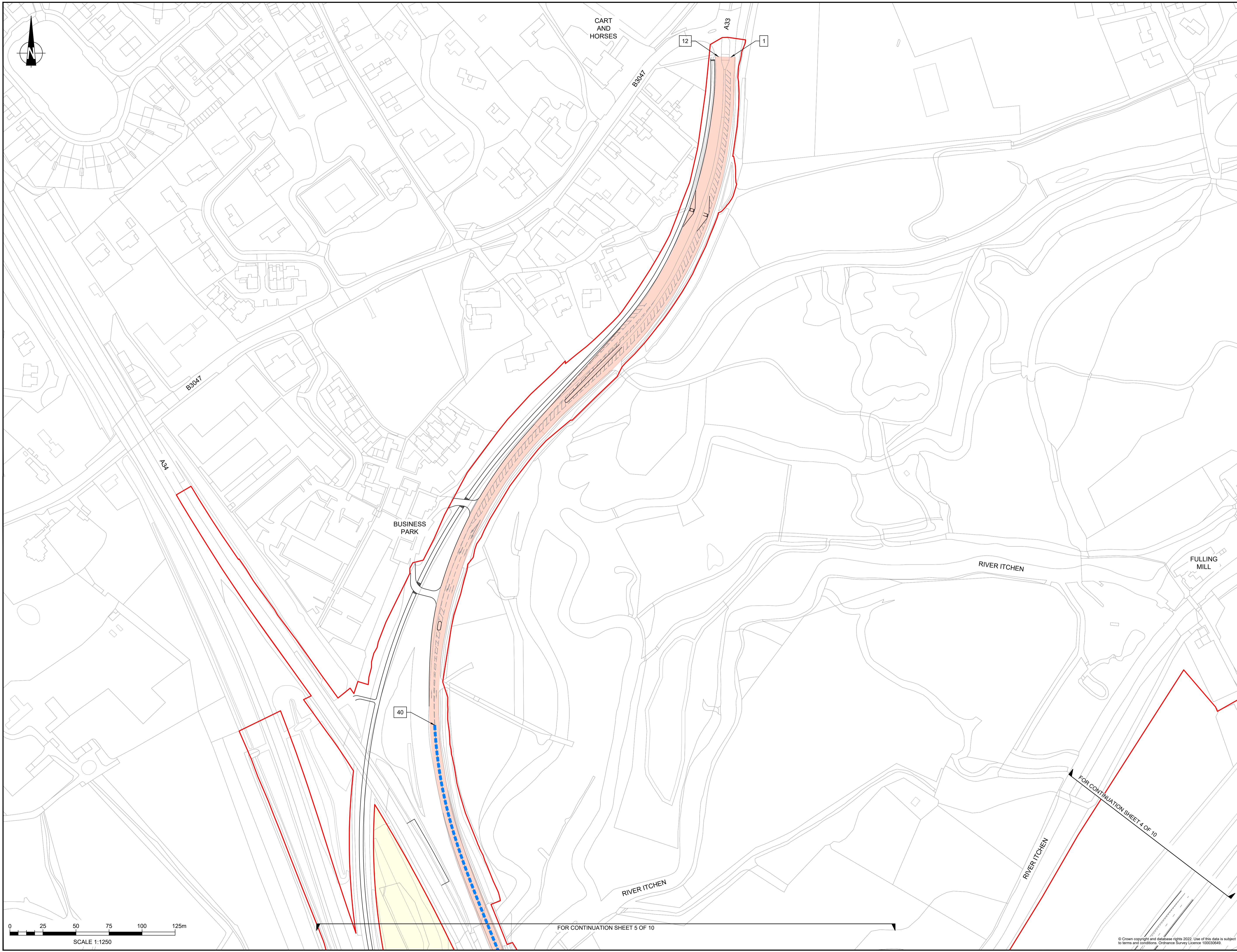

NOTES

Purpose of use
APPLICATION SUBMISSION
 Development Consent Order Number / Document
 TR010055/2.11

- THIS DRAWING HAS BEEN PRODUCED USING CAD SOFTWARE. THEREFORE ALL DIMENSIONS ARE SHOWN IN METRES UNLESS SHOWN OTHERWISE.
- DO NOT SCALE FROM THIS DRAWING. USE ONLY PRINTED DIMENSIONS.
- PROPOSED EARTHWORK EMBANKMENTS / CUTTINGS HAVE BEEN OMITTED FOR CLARITY.
- THE DESIGN SHOWN WILL BE SUBJECT TO DETAILED DESIGN DEVELOPMENT IN ACCORDANCE WITH THE PROVISIONS OF THE DEVELOPMENT CONSENT ORDER.

KEY TO SYMBOLS

- DEVELOPMENT CONSENT ORDER BOUNDARY
- LAND NOT INCLUDED IN ORDER LIMITS
- PROPOSED ROAD MARKINGS
- PROPOSED CLEARWAY EXTENTS
- PROPOSED PROHIBITION OF OVERTAKING EXTENTS
- START / END POINT OF RESTRICTION AS DETAILED IN SCHEDULE 3 OF THE DEVELOPMENT CONSENT ORDER

01	JUNE 2023	DEADLINE 2	EO	LC	MF
0	NOVEMBER 2022	APPLICATION SUBMISSION	GP	LC	MF
REV	DATE	REVISION NOTE	ORIG	CHKD	APPD

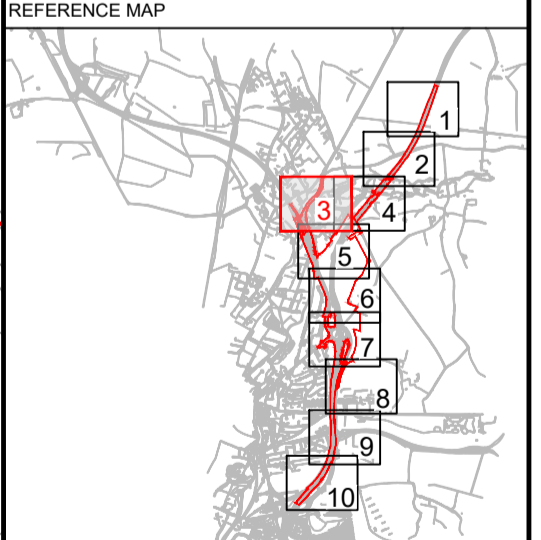

DESIGNER

CONTRACTOR

CLIENT

PROJECT TITLE
M3 JUNCTION 9 IMPROVEMENT SCHEME

PROJECT STAGE
PCF STAGE 3

DRAWING TITLE
**TRAFFIC REGULATION MEASURES
 APFP REGULATION S(2)(c)
 SHEET 3 OF 10
 DOCUMENT REFERENCE: 2.11**

SUITABILITY
APPLICATION SUBMISSION

SHEET SIZE: A1 | SCALE: 1:1,250 | STATUS: REV 01
 DRAWING NUMBER
 HES51511-VFK-LSI-X_XXXX_XX-DR-ZL-8025

FOR CONTINUATION SHEET 5 OF 10

FOR CONTINUATION SHEET 4 OF 10

© Crown copyright and database rights 2022. Use of this data is subject to terms and conditions. Ordnance Survey Licence: 100030449

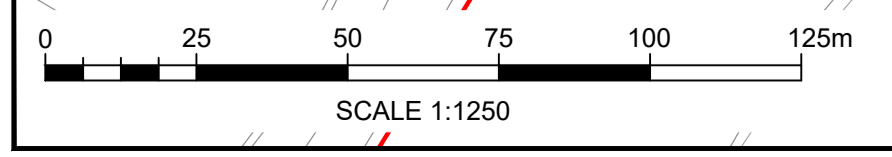
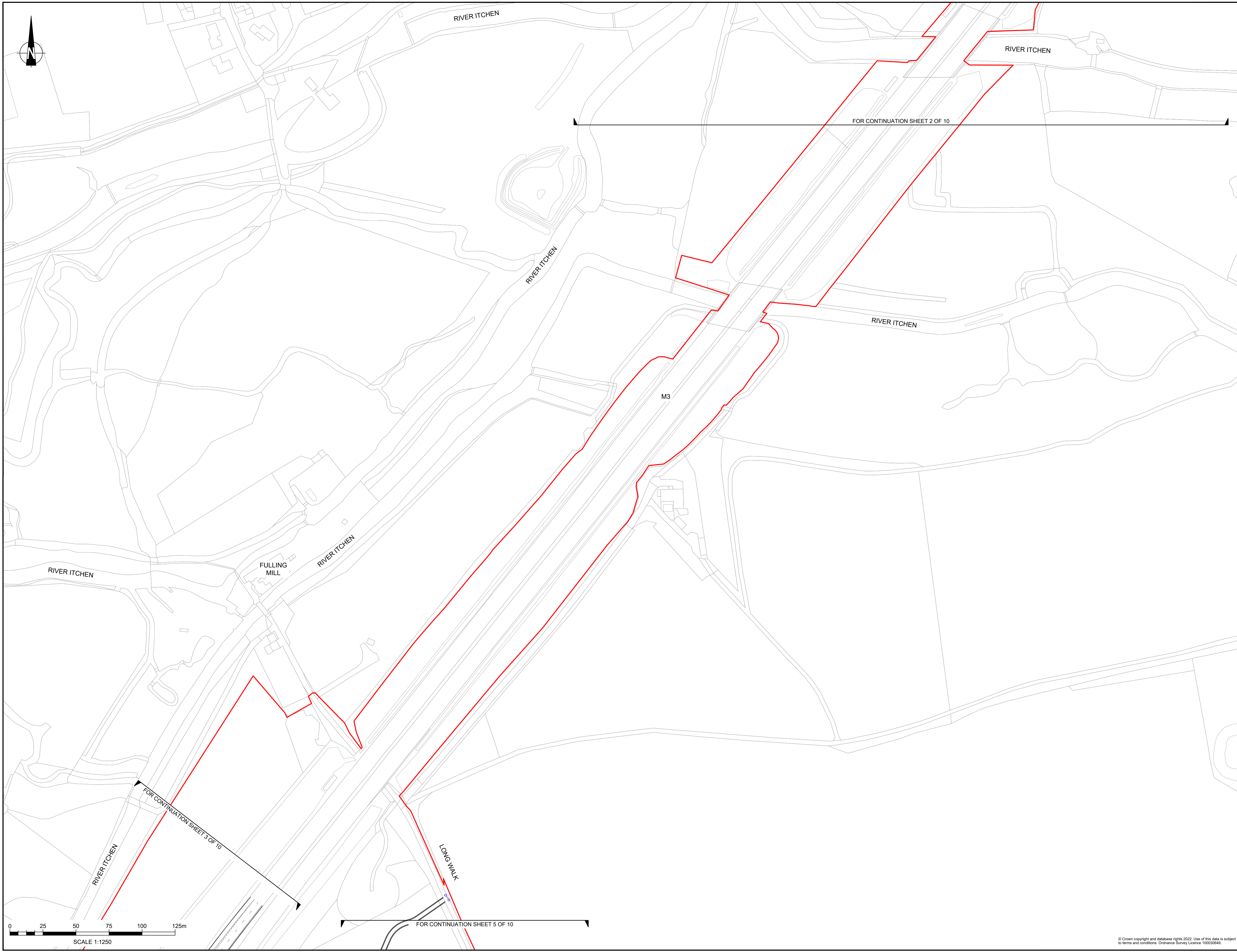

NOTES

Purpose of use
APPLICATION SUBMISSION

Development Consent Order Number / Document
 TR010055/2.11

- THIS DRAWING HAS BEEN PRODUCED USING CAD SOFTWARE. THEREFORE ALL DIMENSIONS ARE SHOWN IN METRES UNLESS SHOWN OTHERWISE.
- DO NOT SCALE FROM THIS DRAWING. USE ONLY PRINTED DIMENSIONS.
- PROPOSED EARTHWORK EMBANKMENTS / CUTTINGS HAVE BEEN OMITTED FOR CLARITY.
- THE DESIGN SHOWN WILL BE SUBJECT TO DETAILED DESIGN DEVELOPMENT IN ACCORDANCE WITH THE PROVISIONS OF THE DEVELOPMENT CONSENT ORDER.

KEY TO SYMBOLS

- DEVELOPMENT CONSENT ORDER BOUNDARY
- LAND NOT INCLUDED IN ORDER LIMITS
- PROPOSED ROAD MARKINGS
- PROPOSED CLEARWAY EXTENTS
- PROPOSED PROHIBITION OF OVERTAKING EXTENTS
- START / END POINT OF RESTRICTION AS DETAILED IN SCHEDULE 3 OF THE DEVELOPMENT CONSENT ORDER

REV	DATE	REVISION NOTE	ORIG	CHKD	APPD
01	JUNE 2023	DEADLINE 2	EO	LC	MF
0	NOVEMBER 2022	APPLICATION SUBMISSION	GP	LC	MF

REFERENCE MAP

DESIGNER

CONTRACTOR

CLIENT

PROJECT TITLE
 M3 JUNCTION 9 IMPROVEMENT SCHEME

PROJECT STAGE
 PCF STAGE 3

DRAWING TITLE
 TRAFFIC REGULATION MEASURES
 APPP REGULATION S(2)(c)
 SHEET 4 OF 10
 DOCUMENT REFERENCE: 2.11

SUITABILITY
 APPLICATION SUBMISSION

SHEET SIZE: A1 SCALE: 1:1250 STATUS: REV 01

DRAWING NUMBER
 HES51511-VFK-LSI-X_XXXX_XX-DR-ZL-6026

© Crown copyright and database rights 2022. Use of this data is subject to terms and conditions. Ordnance Survey Licence: 100030649

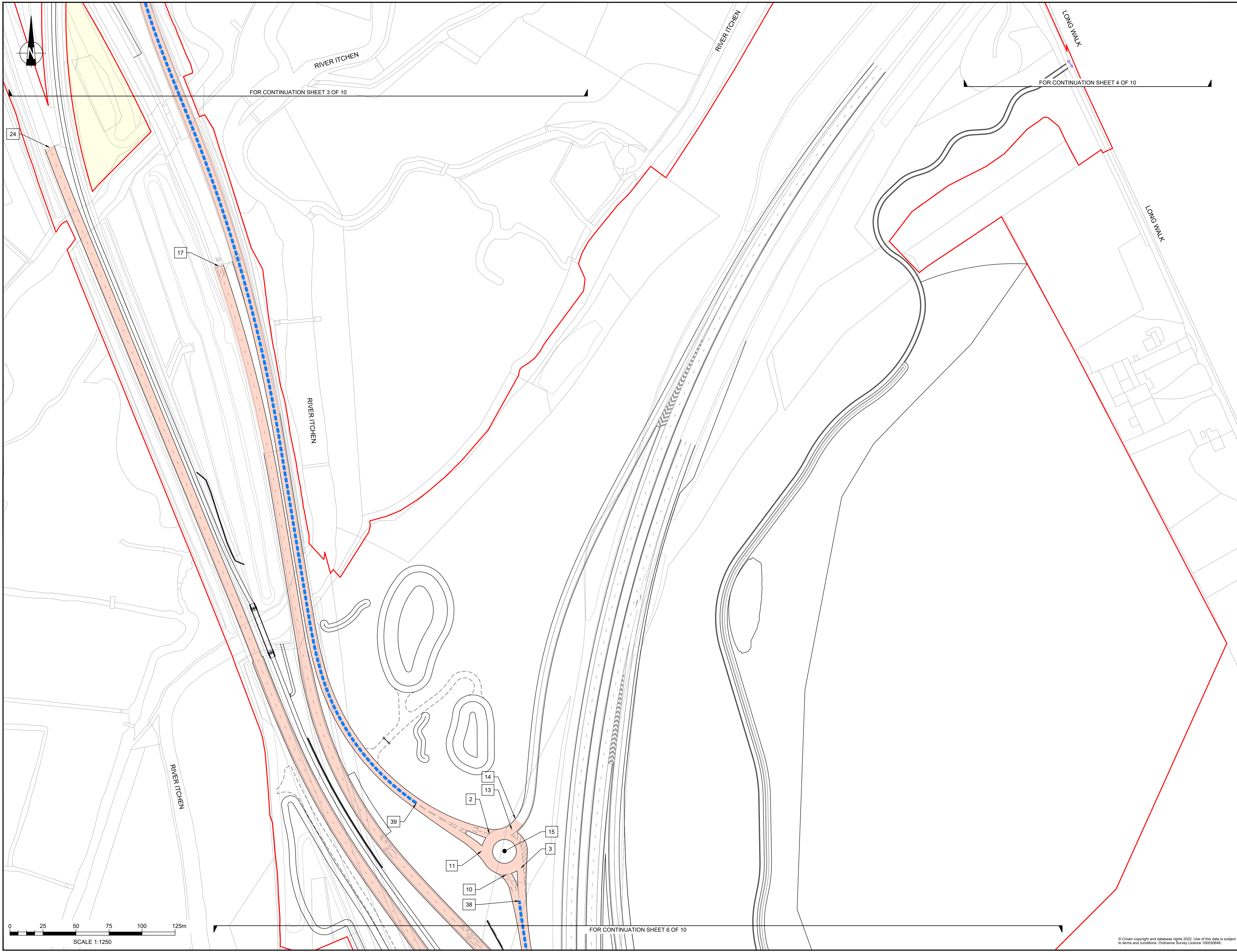

NOTES

Purpose of use
APPLICATION SUBMISSION

Development Consent Order Number / Document
 TR010055/2.11

- THIS DRAWING HAS BEEN PRODUCED USING CAD SOFTWARE. THEREFORE ALL DIMENSIONS ARE SHOWN IN METRES UNLESS SHOWN OTHERWISE.
- DO NOT SCALE FROM THIS DRAWING. USE ONLY PRINTED DIMENSIONS.
- PROPOSED EARTHWORK EMBANKMENTS / CUTTINGS HAVE BEEN OMITTED FOR CLARITY.
- THE DESIGN SHOWN WILL BE SUBJECT TO DETAILED DESIGN DEVELOPMENT IN ACCORDANCE WITH THE PROVISIONS OF THE DEVELOPMENT CONSENT ORDER.

KEY TO SYMBOLS

- DEVELOPMENT CONSENT ORDER BOUNDARY
- LAND NOT INCLUDED IN ORDER LIMITS
- PROPOSED ROAD MARKINGS
- PROPOSED CLEARWAY EXTENTS
- PROPOSED PROHIBITION OF OVERTAKING EXTENTS
- START / END POINT OF RESTRICTION AS DETAILED IN SCHEDULE 3 OF THE DEVELOPMENT CONSENT ORDER

01	JUNE 2023	DEADLINE 2	EO	LC	MF
0	NOVEMBER 2022	APPLICATION SUBMISSION	GP	LC	MF
REV	DATE	REVISION NOTE	ORIG	CHKD	APPD

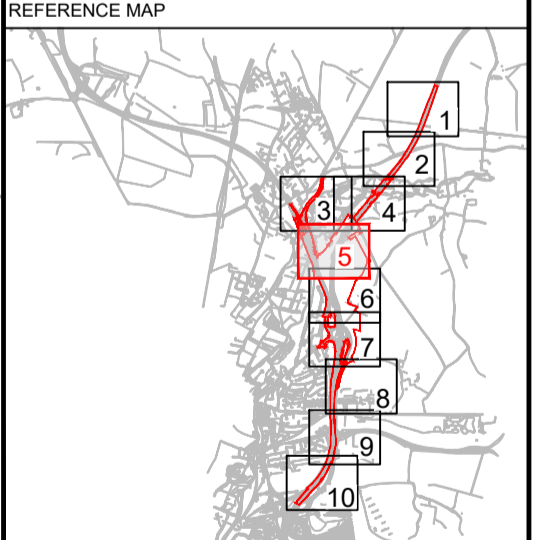

DESIGNER

CONTRACTOR

CLIENT

PROJECT TITLE
 M3 JUNCTION 9 IMPROVEMENT SCHEME

PROJECT STAGE
 PCF STAGE 3

DRAWING TITLE
 TRAFFIC REGULATION MEASURES
 APPP REGULATION S(2)(c)
 SHEET 5 OF 10
 DOCUMENT REFERENCE: 2.11

SUITABILITY
 APPLICATION SUBMISSION

SHEET SIZE: A1 SCALE: 1:1250 STATUS: REV 01

DRAWING NUMBER
 HES51511-VFK-LSI-X_XXXX_XX-DR-ZL-8027

© Crown copyright and database rights 2022. Use of this data is subject to terms and conditions. Ordnance Survey Licence: 100030649

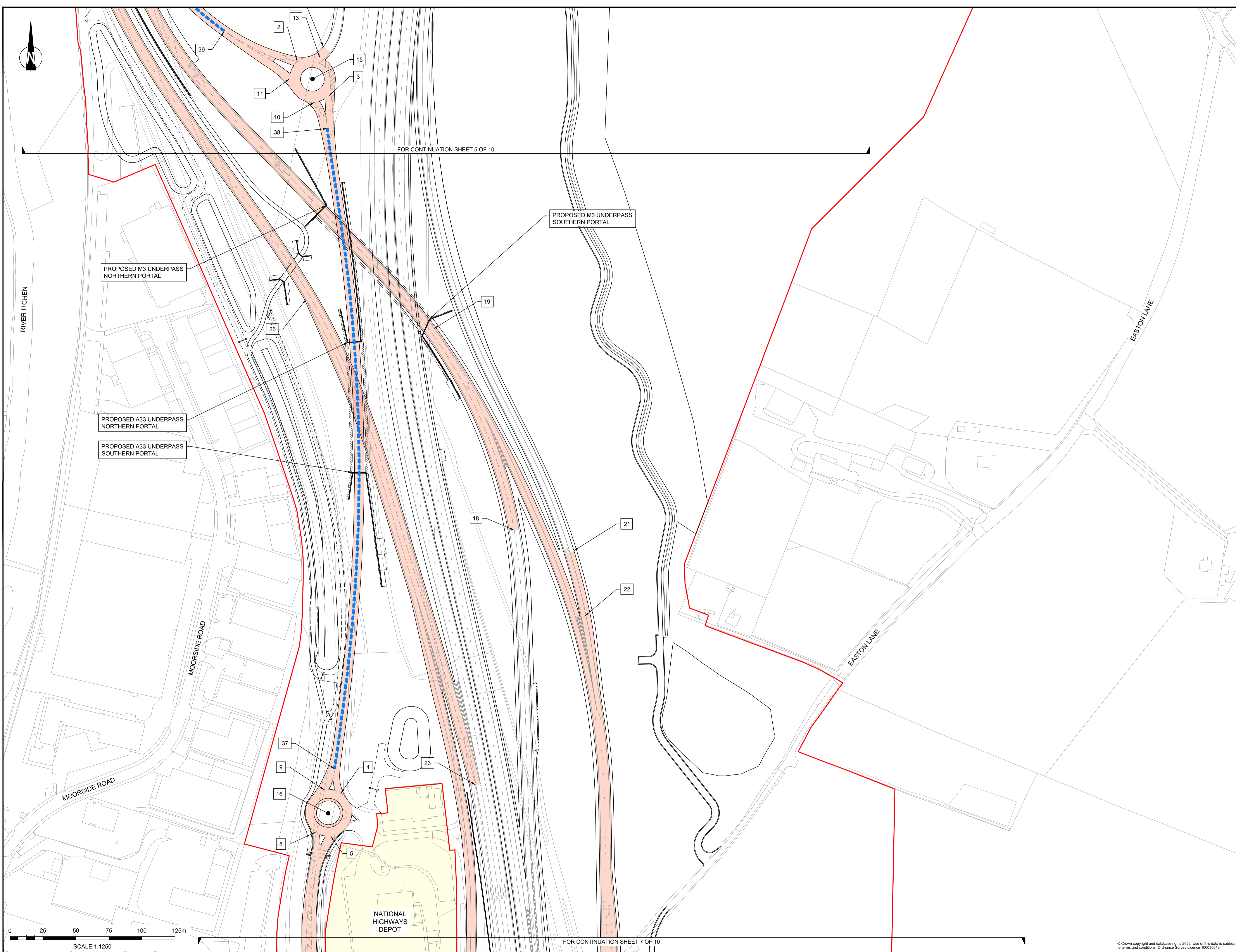

NOTES

Purpose of use
APPLICATION SUBMISSION
 Development Consent Order Number / Document
 TR010055/2.11

- THIS DRAWING HAS BEEN PRODUCED USING CAD SOFTWARE. THEREFORE ALL DIMENSIONS ARE SHOWN IN METRES UNLESS SHOWN OTHERWISE.
- DO NOT SCALE FROM THIS DRAWING. USE ONLY PRINTED DIMENSIONS.
- PROPOSED EARTHWORK EMBANKMENTS / CUTTINGS HAVE BEEN OMITTED FOR CLARITY.
- THE DESIGN SHOWN WILL BE SUBJECT TO DETAILED DESIGN DEVELOPMENT IN ACCORDANCE WITH THE PROVISIONS OF THE DEVELOPMENT CONSENT ORDER.

KEY TO SYMBOLS

- DEVELOPMENT CONSENT ORDER BOUNDARY
- LAND NOT INCLUDED IN ORDER LIMITS
- PROPOSED ROAD MARKINGS
- PROPOSED CLEARWAY EXTENTS
- PROPOSED PROHIBITION OF OVERTAKING EXTENTS
- START / END POINT OF RESTRICTION AS DETAILED IN SCHEDULE 3 OF THE DEVELOPMENT CONSENT ORDER

01	JUNE 2023	DEADLINE 2	EO	LC	MF
0	NOVEMBER 2022	APPLICATION SUBMISSION	GP	LC	MF
REV	DATE	REVISION NOTE	ORIG	CHKD	APPD

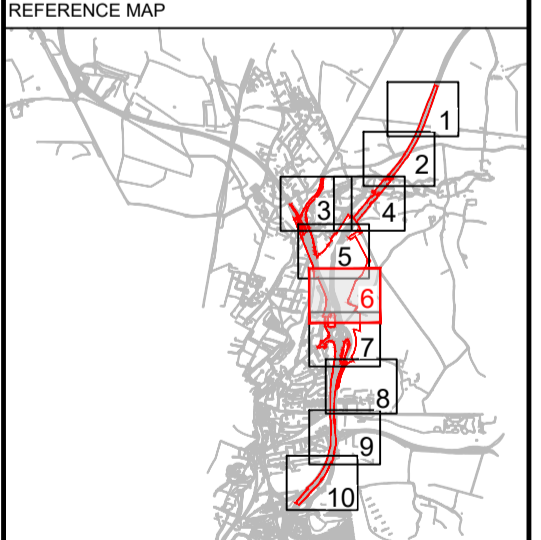

DESIGNER

CONTRACTOR

CLIENT

PROJECT TITLE
M3 JUNCTION 9 IMPROVEMENT SCHEME

PROJECT STAGE
PCF STAGE 3

DRAWING TITLE
**TRAFFIC REGULATION MEASURES
 APPP REGULATION 5(2)(c)
 SHEET 6 OF 10
 DOCUMENT REFERENCE: 2.11**

SUITABILITY
APPLICATION SUBMISSION

SHEET SIZE: A1 SCALE: 1:1250 STATUS: REV 01

DRAWING NUMBER
 HES51511-VFK-LSI-X_XXXX_XX-DR-ZL-6028

© Crown copyright and database rights 2022. Use of this data is subject to terms and conditions. Ordnance Survey Licence 100030649.

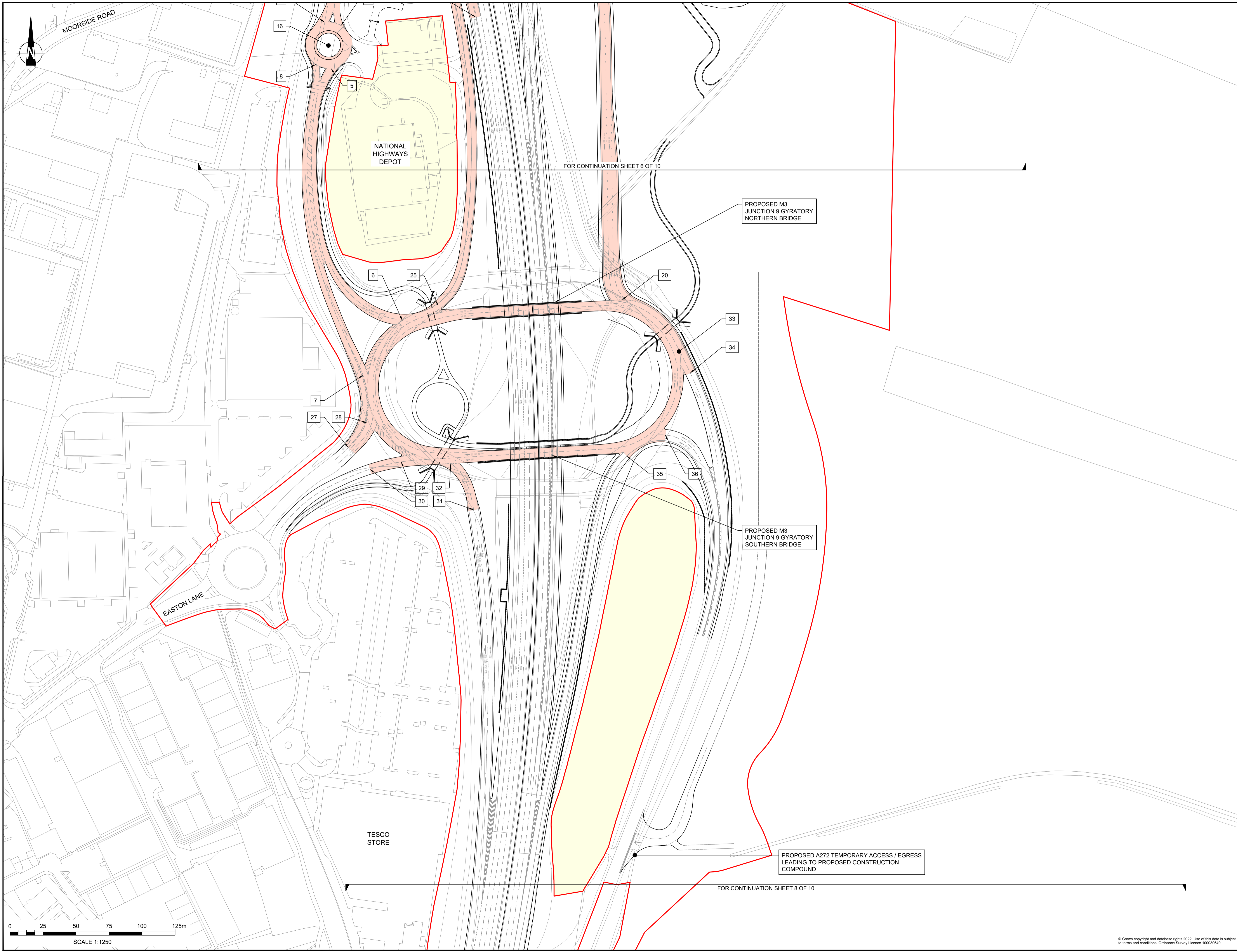

FOR CONTINUATION SHEET 6 OF 10

PROPOSED M3 JUNCTION 9 GYRATORY NORTHERN BRIDGE

PROPOSED M3 JUNCTION 9 GYRATORY SOUTHERN BRIDGE

PROPOSED A272 TEMPORARY ACCESS / EGRESS LEADING TO PROPOSED CONSTRUCTION COMPOUND

FOR CONTINUATION SHEET 8 OF 10

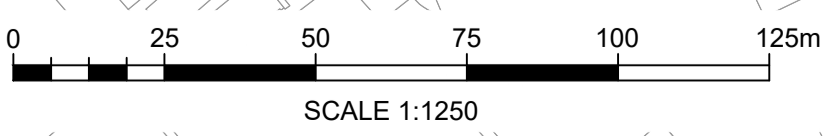

NOTES

Purpose of use
APPLICATION SUBMISSION
 Development Consent Order Number / Document
 TR010055/2.11

- THIS DRAWING HAS BEEN PRODUCED USING CAD SOFTWARE. THEREFORE ALL DIMENSIONS ARE SHOWN IN METRES UNLESS SHOWN OTHERWISE.
- DO NOT SCALE FROM THIS DRAWING. USE ONLY PRINTED DIMENSIONS.
- PROPOSED EARTHWORK EMBANKMENTS / CUTTINGS HAVE BEEN OMITTED FOR CLARITY.
- THE DESIGN SHOWN WILL BE SUBJECT TO DETAILED DESIGN DEVELOPMENT IN ACCORDANCE WITH THE PROVISIONS OF THE DEVELOPMENT CONSENT ORDER.

KEY TO SYMBOLS

- DEVELOPMENT CONSENT ORDER BOUNDARY
- LAND NOT INCLUDED IN ORDER LIMITS
- PROPOSED ROAD MARKINGS
- PROPOSED CLEARWAY EXTENTS
- PROPOSED PROHIBITION OF OVERTAKING EXTENTS
- START / END POINT OF RESTRICTION AS DETAILED IN SCHEDULE 3 OF THE DEVELOPMENT CONSENT ORDER

01	JUNE 2023	DEADLINE 2	EO	LC	MF
0	NOVEMBER 2022	APPLICATION SUBMISSION	GP	LC	MF
REV	DATE	REVISION NOTE	ORIG	CHKD	APPD

REFERENCE MAP

DESIGNER
Stantec

CONTRACTOR
VolkerFitzpatrick

CLIENT
national highways

PROJECT TITLE
M3 JUNCTION 9 IMPROVEMENT SCHEME

PROJECT STAGE
PCF STAGE 3

DRAWING TITLE
**TRAFFIC REGULATION MEASURES
 APPP REGULATION 5(2)(c)
 SHEET 7 OF 10
 DOCUMENT REFERENCE: 2.11**

SUITABILITY
APPLICATION SUBMISSION

SHEET SIZE: A1 SCALE: 1:1250 STATUS: REV 01
 DRAWING NUMBER
 HES51511-VFK-LSI-X_XXXX_XX-DR-ZL-8029

© Crown copyright and database rights 2022. Use of this data is subject to terms and conditions. Ordnance Survey Licence 100030649.

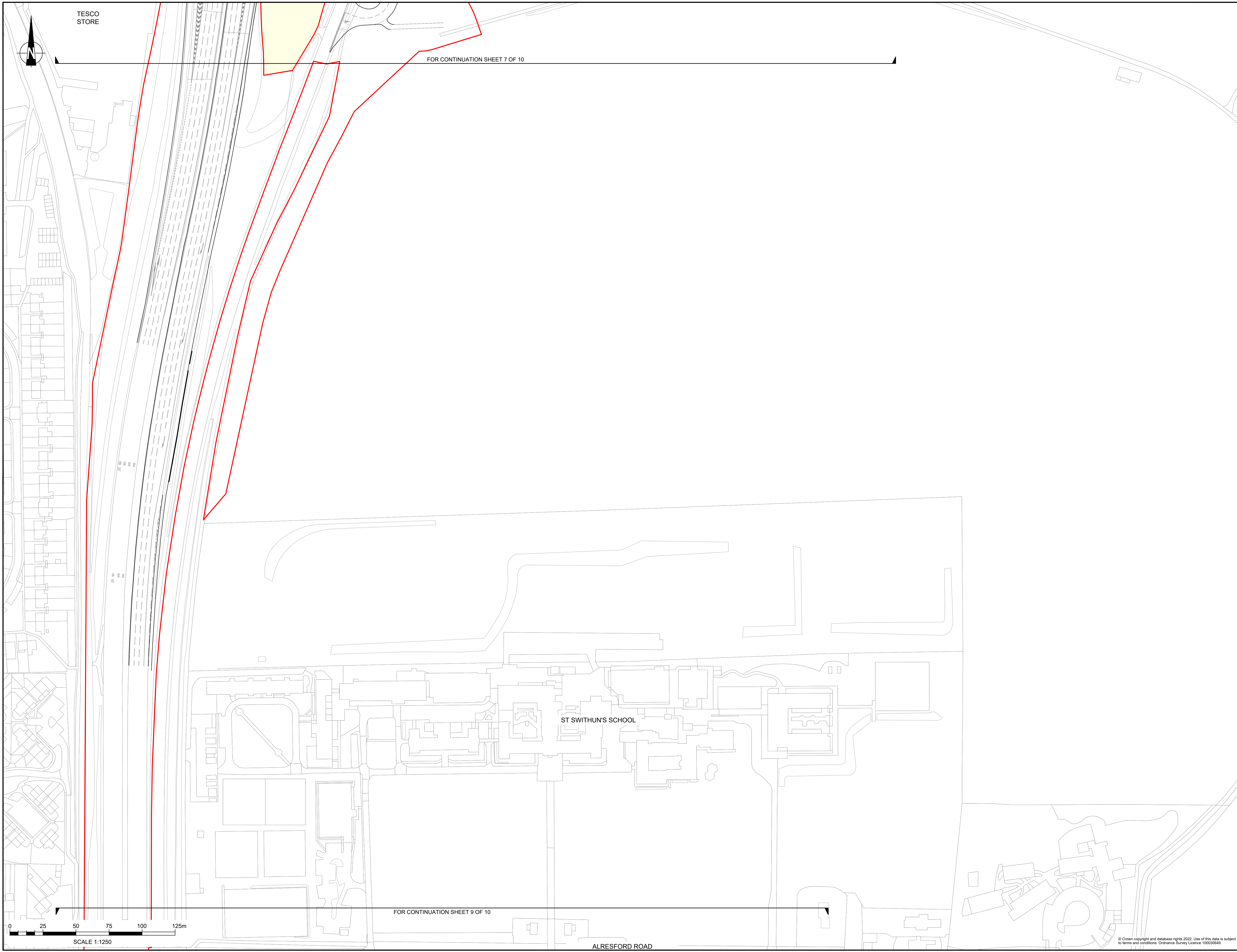

TESCO STORE

FOR CONTINUATION SHEET 7 OF 10

ST SWITHUN'S SCHOOL

ALRESFORD ROAD

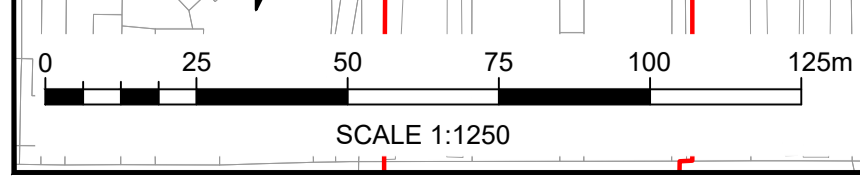

FOR CONTINUATION SHEET 9 OF 10

NOTES

Purpose of use
APPLICATION SUBMISSION
 Development Consent Order Number / Document
 TR010055/2.11

- THIS DRAWING HAS BEEN PRODUCED USING CAD SOFTWARE. THEREFORE ALL DIMENSIONS ARE SHOWN IN METRES UNLESS SHOWN OTHERWISE.
- DO NOT SCALE FROM THIS DRAWING. USE ONLY PRINTED DIMENSIONS.
- PROPOSED EARTHWORK EMBANKMENTS / CUTTINGS HAVE BEEN OMITTED FOR CLARITY.
- THE DESIGN SHOWN WILL BE SUBJECT TO DETAILED DESIGN DEVELOPMENT IN ACCORDANCE WITH THE PROVISIONS OF THE DEVELOPMENT CONSENT ORDER.

KEY TO SYMBOLS

- DEVELOPMENT CONSENT ORDER BOUNDARY
- LAND NOT INCLUDED IN ORDER LIMITS
- PROPOSED ROAD MARKINGS
- PROPOSED CLEARWAY EXTENTS
- PROPOSED PROHIBITION OF OVERTAKING EXTENTS
- START / END POINT OF RESTRICTION AS DETAILED IN SCHEDULE 3 OF THE DEVELOPMENT CONSENT ORDER

01	JUNE 2023	DEADLINE 2	EO	LC	MF
0	NOVEMBER 2022	APPLICATION SUBMISSION	GP	LC	MF
REV	DATE	REVISION NOTE	ORIG	CHKD	APPD

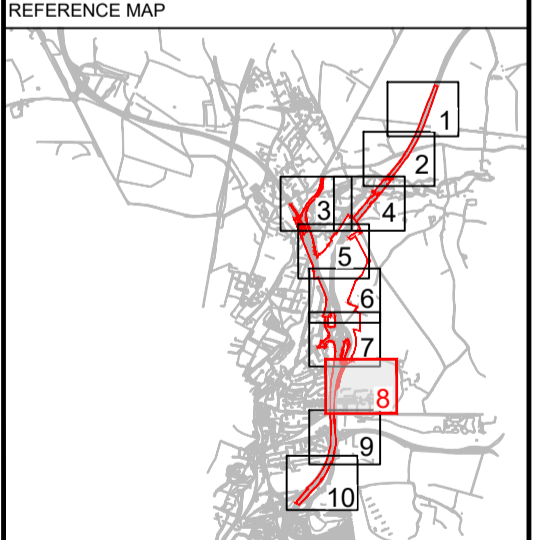

DESIGNER

CONTRACTOR

CLIENT

PROJECT TITLE
 M3 JUNCTION 9 IMPROVEMENT SCHEME

PROJECT STAGE
 PCF STAGE 3

DRAWING TITLE
 TRAFFIC REGULATION MEASURES
 APPP REGULATION 5(2)(c)
 SHEET 8 OF 10
 DOCUMENT REFERENCE: 2.11

SUITABILITY
 APPLICATION SUBMISSION

SHEET SIZE: A1 SCALE: 1:1250 STATUS: REV 01

DRAWING NUMBER
 HES51511-VFK-LSI-X_XXXX_XX-DR-ZL-8030

© Crown copyright and database rights 2022. Use of this data is subject to terms and conditions. Ordnance Survey Licence 100030649.

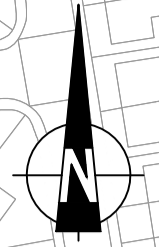
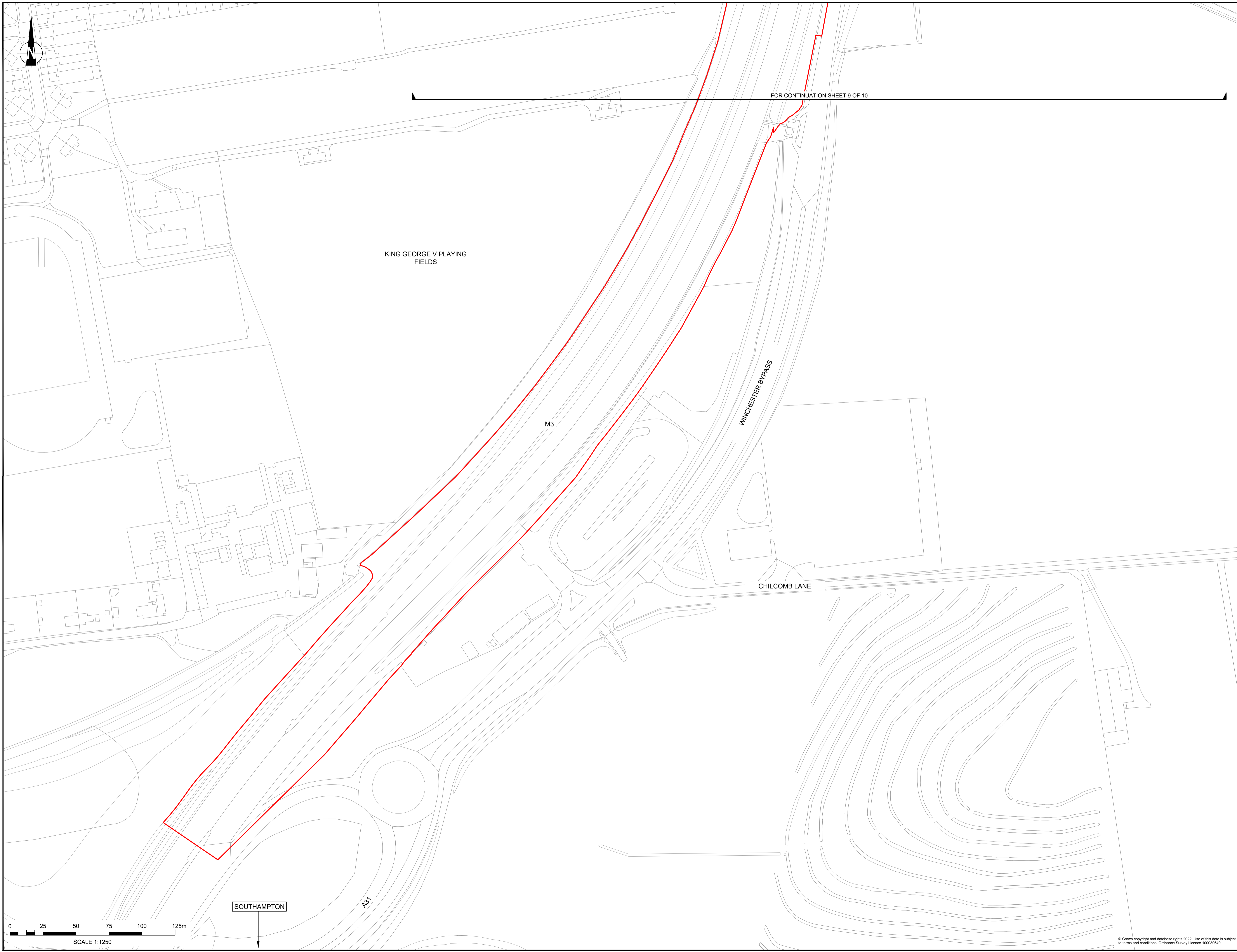

FOR CONTINUATION SHEET 9 OF 10

KING GEORGE V PLAYING FIELDS

M3

WINCHESTER BYPASS

CHILCOMB LANE

SOUTHAMPTON

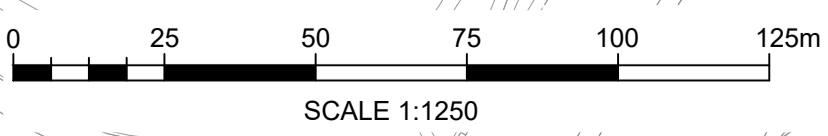

NOTES
 Purpose of use
APPLICATION SUBMISSION
 Development Consent Order Number / Document
 TR010055/2.11

- THIS DRAWING HAS BEEN PRODUCED USING CAD SOFTWARE. THEREFORE ALL DIMENSIONS ARE SHOWN IN METRES UNLESS SHOWN OTHERWISE.
- DO NOT SCALE FROM THIS DRAWING. USE ONLY PRINTED DIMENSIONS.
- PROPOSED EARTHWORK EMBANKMENTS / CUTTINGS HAVE BEEN OMITTED FOR CLARITY.
- THE DESIGN SHOWN WILL BE SUBJECT TO DETAILED DESIGN DEVELOPMENT IN ACCORDANCE WITH THE PROVISIONS OF THE DEVELOPMENT CONSENT ORDER.

- KEY TO SYMBOLS
- DEVELOPMENT CONSENT ORDER BOUNDARY
 - LAND NOT INCLUDED IN ORDER LIMITS
 - PROPOSED ROAD MARKINGS
 - PROPOSED CLEARWAY EXTENTS
 - PROPOSED PROHIBITION OF OVERTAKING EXTENTS
 - START / END POINT OF RESTRICTION AS DETAILED IN SCHEDULE 3 OF THE DEVELOPMENT CONSENT ORDER

REV	DATE	REVISION NOTE	ORIG	CHKD	APPD
01	JUNE 2023	DEADLINE 2	EO	LC	MF
0	NOVEMBER 2022	APPLICATION SUBMISSION	GP	LC	MF

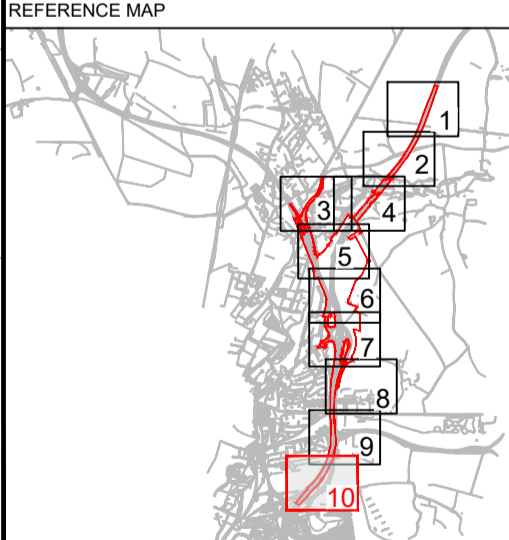

DESIGNER

CONTRACTOR

CLIENT

PROJECT TITLE
 M3 JUNCTION 9 IMPROVEMENT SCHEME

PROJECT STAGE
 PCF STAGE 3

DRAWING TITLE
 TRAFFIC REGULATION MEASURES
 APPFP REGULATION S(2)(c)
 SHEET 10 OF 10
 DOCUMENT REFERENCE: 2.11

SUITABILITY
 APPLICATION SUBMISSION

SHEET SIZE: A1 SCALE: 1:1250 STATUS: REV 01
 DRAWING NUMBER
 HES51511-VFK-LSI-X_XXX_XX-DR-ZL-8032

© Crown copyright and database rights 2022. Use of this data is subject to terms and conditions. Ordnance Survey Licence: 100030649

1. THIS DRAWING HAS BEEN PRODUCED USING CAD SOFTWARE. THEREFORE ALL DIMENSIONS ARE SHOWN IN METRES UNLESS SHOWN OTHERWISE.
2. DO NOT SCALE FROM THIS DRAWING. USE ONLY PRINTED DIMENSIONS.
3. PROPOSED EARTHWORK EMBANKMENTS / CUTTINGS HAVE BEEN OMITTED FOR CLARITY.
4. THE DESIGN SHOWN WILL BE SUBJECT TO DETAILED DESIGN DEVELOPMENT IN ACCORDANCE WITH THE PROVISIONS OF THE DEVELOPMENT CONSENT ORDER.

KEY TO SYMBOLS

- DEVELOPMENT CONSENT ORDER BOUNDARY
- LAND NOT INCLUDED IN ORDER LIMITS
- PROPOSED ROAD MARKINGS
- PROPOSED CLEARWAY EXTENTS
- PROPOSED PROHIBITION OF OVERTAKING EXTENTS
- START / END POINT OF RESTRICTION AS DETAILED IN SCHEDULE 3 OF THE DEVELOPMENT CONSENT ORDER

01	JUNE 2023	DEADLINE 2	EO	LC	MF
0	NOVEMBER 2022	APPLICATION SUBMISSION	GP	LC	MF
REV	DATE	REVISION NOTE	ORIG	CHKD	APPD

REFERENCE MAP

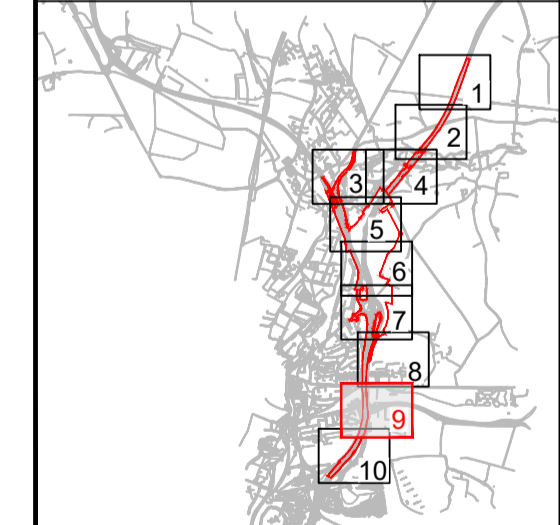

DESIGNER

CONTRACTOR

CLIENT

PROJECT TITLE
M3 JUNCTION 9 IMPROVEMENT SCHEME

PROJECT STAGE
PCF STAGE 3

DRAWING TITLE
TRAFFIC REGULATION MEASURES
APFP REGULATION S(2)(c)
SHEET 9 OF 10
DOCUMENT REFERENCE: 2.11

SUITABILITY
APPLICATION SUBMISSION

SHEET SIZE: A1 | SCALE: 1:1,250 | STATUS: REV 01

DRAWING NUMBER
HES51511-VFK-LSI-X_XXXX_XX-DR-ZL-8031

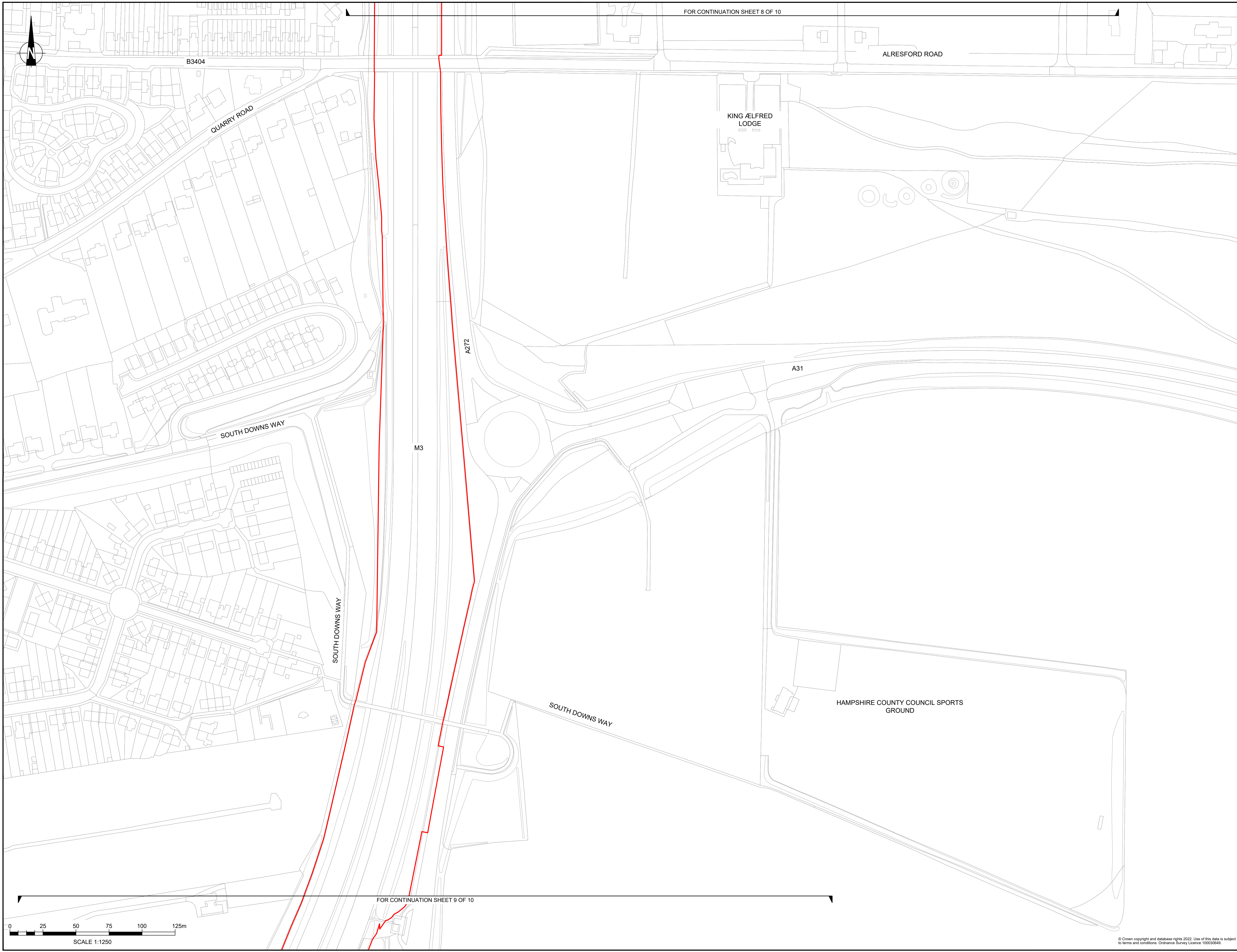

B3404

QUARRY ROAD

SOUTH DOWNS WAY

SOUTH DOWNS WAY

M3

A272

A31

KING ALFRED LODGE

SOUTH DOWNS WAY

HAMPSHIRE COUNTY COUNCIL SPORTS GROUND

